

HFD-FO-232 Series

RS-232 Multi-Drop Bus Fiber Optic Modem



Product Description

The HFD series RS-232 Multi-Drop Bus Fiber Optic Modem series products provide an optical bus network for RS-232, RS-422 or RS-485 data interfaces over a pair of multi mode or single mode optical fibers. The Terminal module units operate as the end or terminal points and provide an electrical connection and a two fiber optical connection. The Repeater module units act as in-line repeater stations and provide a single electrical connection and two optical connections, one upstream and one downstream. This series is available in either wall mount, DIN rail or 2U chassis card configurations.

Product Features

- ◆ Multi protocol data interface
- ◆ Switchable termination and biasing
- ◆ Multi mode and single mode
- ◆ Single or dual redundant power supply
- ◆ 5 years warranty

Typical System Configuration

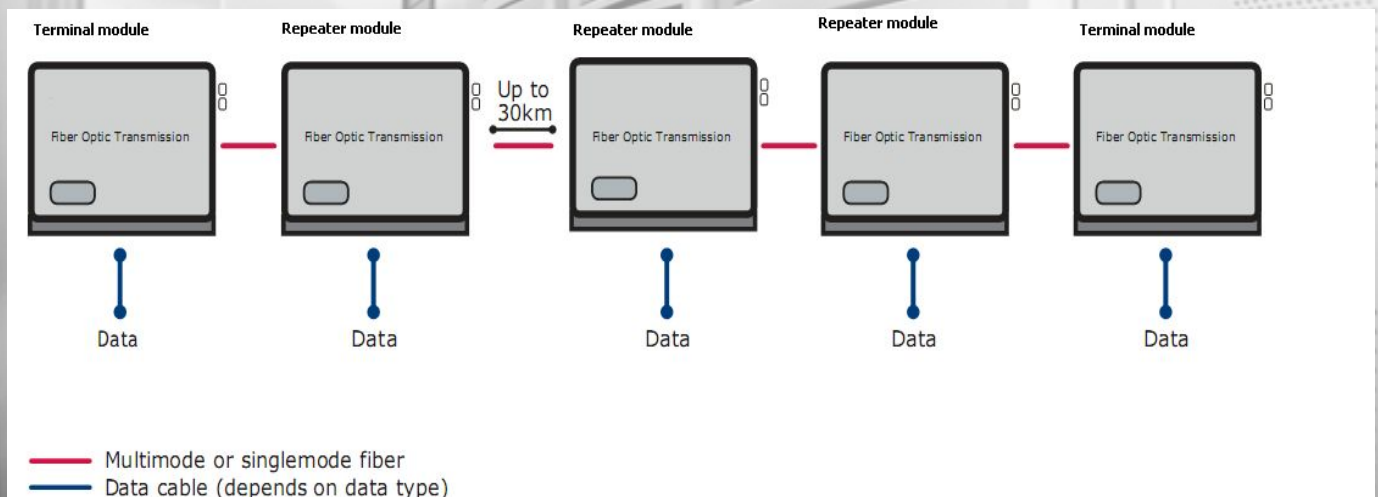

Specifications:

Data	
Data Formats	RS232,RS422,RS485
RS232 Data Rate	115.2kbps
RS422/485 Data Rate	512kbps
Bit Error Rate	<1 x 10 ⁻¹²
Connectors	
Data	DB9
Fiber	ST, SC or FC (ST fitted as standard)
Environmental	
Operating Temperature	-30C---+70C
Storage Temperature	-40C---+90C
Operating Humidity	0-95%
MTBF	>100,000 Hours
Optical	
Fiber	Multi mode or single mode
Wavelength	MM:850nm,SM:1310nm
Number of fibers	4 or 2(WDM,Bi-Di)
POWER	
Power Input	AC 220V 110v or DC+110V ,+5V ,+12V ,+24V, +48V Option
Mechanical	
Dimensions	43(W)×88.5(D)×124.5(H)mm DIN Rail

Model Selection:

Model Number	Description	Fiber No.	Fiber Mode	Fiber Connector
HFD-FO-232-M2M	Multi Drop Link,Dual Fiber(BI-DI), 2km	2	Multi Mode	ST/SC/FC
HFD-FO-232-M4M	Multi Drop Link,4 Fiber, 2km	4	Multi Mode	ST/SC/FC
HFD-FO-232-M2S	Multi Drop Link,Dual Fiber(BI-DI), 20km	2	Single Mode	ST/SC/FC
HFD-FO-232-M4S	Multi Drop Link,4 Fiber, 20km	4	Single Mode	ST/SC/FC